

**Kausche ähnlich DIN 6899 Typ BF**  
**Import**, verzinkt

**Thimble similar to DIN 6899 type BF**  
**Import**, galvanized

| RW<br>groove RW<br>mm | c<br>mm | l<br>ca. mm<br>approx. mm | s<br>mm | Gewicht<br>per 100 Stk. kg<br>weight per<br>100 pcs. kg | Artikelnummer<br>stock no. |
|-----------------------|---------|---------------------------|---------|---|----------------------------|
| 3                     | 12      | 19                        | 1,1     | 0,5   | 110 311 003                |
| 4                     | 13      | 21                        | 1,1     | 0,5   | 110 311 004                |
| 5                     | 14      | 23                        | 1,6     | 0,8   | 110 311 005                |
| 6                     | 16      | 25                        | 1,7     | 2,0   | 110 311 006                |
| 8                     | 20      | 32                        | 2       | 4,0   | 110 311 008                |
| 10                    | 24      | 38                        | 3,5     | 4,0   | 110 311 010                |
| 12                    | 28      | 45                        | 3,5     | 7,0   | 110 311 012                |
| 14                    | 32      | 51                        | 3,5     | 9,0   | 110 311 014                |
| 16                    | 36      | 58                        | 4       | 15,0  | 110 311 016                |
| 18                    | 40      | 64                        | 6       | 20,0  | 110 311 018                |
| 20                    | 45      | 72                        | 6       | 28,0  | 110 311 020                |
| 22                    | 50      | 80                        | 6       | 34,0  | 110 311 022                |
| 24                    | 56      | 90                        | 8       | 55,0  | 110 311 024                |
| 26                    | 62      | 99                        | 6,5     | 65,0  | 110 311 026                |
| 28                    | 70      | 112                       | 8       | 79,0  | 110 311 028                |
| 30                    | 75      | 120                       | 8       | 108,0   | 110 311 030                |
| 32                    | 80      | 128                       | 8       | 109,0   | 110 311 032                |
| 34                    | 95      | 152                       | 9       | 141,0   | 110 311 034                |
| 36                    | 100     | 160                       | 9       | 162,0   | 110 311 036                |
| 38                    | 110     | 176                       | 9       | 183,0   | 110 311 038                |

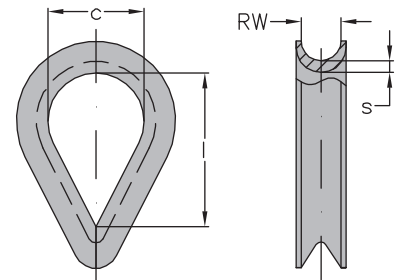

Das Maß c entspricht dem Bolzen-Ø.

*Dimension c corresponds to the bolt diameter.*

**Wichtiger Hinweis:** Bei diesen Kauschen handelt es sich um Importware!  
**Important note:** *These thimbles are imported!*